



AIRCHARGE B2B PRODUCT RANGE

JUNE 2023

THE LARGEST WIRELESS CHARGING BRAND



Aircharge is the WORLD-LEADING provider of wireless charging solutions for
PUBLIC VENUES, TRANSPORT & WORKSPACES



SURFACE CHARGER
15W AIR1510 Range

Our Trusted Original
Upgraded to 15W
Fast Charge
performance.





GEN 2
SURFACE CHARGER
15W AIR1521 Range

A new level of
sophistication & Fast
Charge performance.
Interchangeable Clip
in Brandable Top.
Glass or Nylon Finish.
A Marketing Dream.



(((⚡)))
aircharge®

PRO
15W WIRELESS
CHARGER

20mm Central Drilled
Hole Only.
All Design Options
Available. Branded etc.





FAST SURFACE CHARGER 15W

A new level of
sophistication &
performance



Black Nylon



White Nylon



Black Glass



White Glass



Alu Ring/Glass



Co-Branded

The 15W Aircharge Surface Charger sets the standard for infrastructure-grade wireless charging solutions. With a durable water and dust proof outer casing, this wireless charger can be installed in any desk, table or counter to provide fast charging wireless power in public venues 24/7.

15W

FAST
CHARGING



Qi
CERTIFIED



OPTIMAL
PERFORMANCE



ADDED
PROTECTIONS

KEY FEATURES:

- Fast charging up to 15W
- High-end materials
- Premium design
- Overcurrent, overheat, overvoltage and foreign object protection
- Aircharge+ Compatible

PRODUCT SPECIFICATIONS:

- Qi version: Qi Certified
- Input: QC2.0 Minimum
- Coil: 1 coil Output: up to 15W



SUB-SURFACE
WIRELESS CHARGER
15W

An integral part of the
furniture. Fixed 3mm
Below the Surface for
Seamless Integration.





SUB-SURFACE FAST WIRELESS CHARGER 15W

An Integral Part of the
Furniture

Installed from the underside of a desk or table, the Aircharge Wireless Sub-Surface Charger becomes an integral part of the furniture, maintaining the look & feel of the surface completely intact.

Available with data connectivity for system monitoring, analytics & over-the-air updates.



KEY FEATURES:

- Fits any desk thicknesses – a 80mm Ø housing will be drilled from the underside of the table leaving maximum 3mm for optimal efficiency
- Qi-Certified - supports all Qi compatible devices and Aircharge accessories up to 15W
- Safety protections - Foreign Object Detection, Overcharge protection, Temperature Sensor Control
- Can be secured to underside of work surface using steel plate and screws provided
- USB power cable allows multiple units to be connected to a hub (supplied separately)
- Data connectivity supported
- Please note: As device cases vary in thicknesses we recommend a depth of 2mm, and a maximum depth of 3mm

PRODUCT SPECIFICATIONS:

- Input: QC2.0 Minimum
- Power cable: 2m USB
- Frequency: 100-200kHz
- Certification: Qi-Certified



AirMag MagSafe WIRELESS CHARGER 20W

The Worlds First B-B Apple MagSafe Charger. Available in Black or Silver, the Magnetic contact means The charging Sweet spot is Hit Every time. Also charges all Qi Compatible Devices.

Only requires 16mm Drill Hole for Table Top integration. Can be designed directly into Products such as sofas.

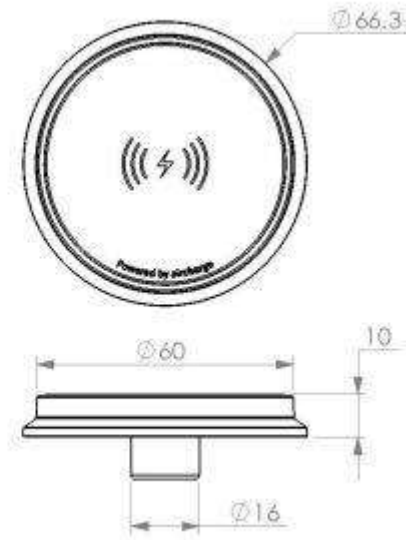



AirMag MagSafe WIRELESS CHARGER 20W

The Worlds First B-B Apple MagSafe Charger. Available in Black or Silver, the Magnetic contact means The charging Sweet spot is Hit Every time. Also charges all Qi Compatible Devices.

Only requires 16mm Drill Hole for Table Top integration. Can be designed directly into Products such as sofas.

The Aircharge AirMag provides a stylish and durable wireless charger featuring Apple's MagSafe device alignment technology, which ensures that your device stays securely in place while charging.

The AirMag requires a single 16mm hole to route the cable and attach the included surface fixing kit, making it easy to install and use.

With the AirMag, you can enjoy the benefits of fast and publicly accessible charging without the need for cables, making it a hassle-free experience for everyone

20W

FAST
CHARGING



Qi
CERTIFIED



OPTIMAL
PERFORMANCE



ADDED
PROTECTIONS

KEY FEATURES:

- Fits any desk thicknesses – a 16mm \varnothing
- Qi-Certified - supports all Qi compatible devices and Aircharge accessories up to 20W
- Safety protections - Foreign Object Detection, Overcharge protection, Temperature Sensor Control
- Anodised Aluminium & Gorilla Glass
- Can be secured to underside of work surface using steel plate and screws provided
- Type-C USB power cable allows multiple units to be connected to a hub (supplied separately)
- Data connectivity supported

PRODUCT SPECIFICATIONS:

- Input: PD3.0 Minimum
- Power cable: 1-2m USB
- Certification: Qi-Certified
- MFI Certified



AirMag DUAL PRO 20W WIRELESS CHARGER

Power up to four
devices at once
1 x MagSafe charger
2 x Type-A USB
1 x Type-C USB
2 x Mains Outlet



Product Description

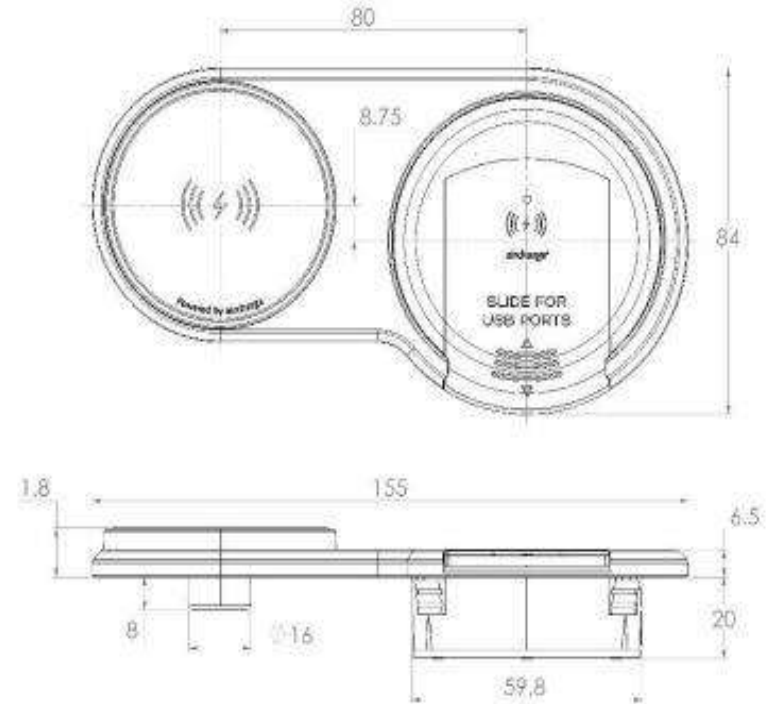



AirMag DUAL PRO WIRELESS CHARGER

Power up to four
devices at once

The innovative Aircharge AirMag Dual Pro Charger combines the benefits of Qi MagSafe wireless and Type-C wired fast charging to power up to 4 devices simultaneously, including laptops.



KEY FEATURES:

- High-power desktop module specifically developed for the modern office environment
- Integrated solution to deliver practical multi-device access to power
- Up to 20W Qi & MFI Certified Fast Wireless Charging
- Lid cover slides to reveal the USB Type-C output and two additional USB Type-A outputs.
- 60W laptop charging without a traditional brick power cord
- Installed at surface level into a standard 80mm desk grommet and 16mm for MagSafe powered via PD3.0 and Mains power source
- Compatible with Aircharge+

PRODUCT SPECIFICATIONS:

- Finish/Colour: Glass Black/White and Base Silver/Black
- Input: 100-240V / 2A 50 / 60Hz
- Aircharge Unit: 120W DC 5V / 2A 9V / 1.7A
- C-Charge Unit: 96W DC 22.5-24V 4.3A Total
- Power Cable: 1-2M Type-C USB and 1.3M Mains Power Cable
- Certification: Qi-Certified MFI Certified



DUAL PRO
15W WIRELESS
CHARGER

Power up to four
devices at once
1 x Wireless charger
2 x Type-A USB
1 x Type-C USB
Off 1 x Mains Outlet





DUAL PRO WIRELESS CHARGER

Power up to four
devices at once

The innovative Aircharge Dual Pro Charger combines the benefits of Qi wireless and Type-C wired fast charging to power up to 4 devices simultaneously, including laptops.



KEY FEATURES:

- High-power desktop module specifically developed for the modern office environment
- Integrated solution to deliver practical multi-device access to power
- Up to 10W Qi-Certified Fast Wireless Charging
- Lid cover slides to reveal the USB Type-C output and two additional USB Type-A outputs.
- 65W laptop charging without a traditional brick power cord
- Installed at surface level into a standard 80mm desk grommet and powered via a single power source
- Compatible with Aircharge+

PRODUCT SPECIFICATIONS:

- Finish/Colour: Glass Black/White and Base Silver/Black
- Input: 100-240V / 2A 50 / 60Hz
- Aircharge Unit: 10W DC 5V / 2A 9V / 1.7A
- C-Charge Unit: 96W DC 22.5-24V 4.3A Total
- Power Cable: 1.3M USB and 1.3M Power Cable
- Frequency: 110-205KHz
- Certification: Qi-Certified



PORTABLE
15W BATTERY PACK

Mobile Wireless
Charging





PORTABLE 15W BATTERY PACK

Battery with:
2 x Type-C
Connectors.
1 x Fly Lead.
Compatible with All
aircharge Wireless
Chargers.

First-to-market battery powered wireless charging technology to bring wireless charging to venues without direct access to power.



KEY FEATURES:

- Unique solution including an intelligent charging rack and 5 rechargeable 18,000 mAh capacity battery pucks with Type-C Fly Lead for Laptop Charging.
- Additional battery pucks can be purchased separately
- Modular design - When combined with an Aircharge Wireless Surface Charger a full ready to use wireless charging solution is formed (Surface Charges suitable for use with Battery Powered Product are sold separately)
- Interchangeable battery pucks for rapid swap out
- Key-secured twist and lock mechanism for safe and easy deployment under the table or counter surface
- Each battery puck guarantees 6 full charging cycles (Based on wirelessly charging Apple iPhone 10 & Full Laptop charge. A recharge cycle is defined as charging the battery from zero to 100%)

IDEAL FOR:

- Restaurants, bars and cafés with furniture which is not fixed or is moved regularly
- Office break out areas
- Malls and shops
- Hotel, train station and airport lounges and waiting areas
- Events and exhibitions



15W
WIRELESS CHARGING
DESK MAT

For the Bureau
/Desktop / Workspace





WIRELESS CHARGING DESK MAT

For the Workspace

The Aircharge Wireless Charging Desk Mat divides the work space into stylish and comfortable personal areas, incorporating Wireless Charging without any fixed installations. Space is allocated for the Orb wireless charging adaptor and there is a groove to hold your phone or tablet at an ergonomic angle.



KEY FEATURES:

- Tempered Gorilla Glass Wireless Charger
- Soft-touch finish for optimal usability
- Ergonomically designed to ensure comfort

PRODUCT SPECIFICATIONS:

- Finish/colour: Black
- Materials: PU
- Power cable: 2m USB
- Input: QC.2 Minimum, (plug must be this specification)
- Frequency: 100-200kHz
- Dimensions: 500mm x 700mm x 19mm
(Weight:1150g)

(((⚡)))
aircharge®

Z-BAR
WIRELESS CHARGING
LAMP

Award winning design
with integrated
wireless charging
function





Z-BAR WIRELESS CHARGING LAMP

Award winning design
with integrated
wireless charging
function

The award winning Koncept Z-Bar Mini task light is now available with Aircharge wireless charging integrated into the base - the ideal solution to light your space and keep your device topped up.



Colours: Red, Green, Orange, Purple, Blue, Black, White

KEY FEATURES:

- Stylish modern design
- In-built wireless charger
- Three bar design
- Touch & go switch
- No bulky bulbs
- Works with all Qi-enabled wireless phone chargers

PRODUCT SPECIFICATIONS:

- Number of LEDs: 28
- LED rated lifespan: 50000 hours
- Energy consumption: 7 watts
- Colour temp. (daylight): 5000K
- Colour rendering index: 85
- Dimensions: 320mm x 305mm x 346mm
- Weight: 1840g
- Charger input: DC 5V, 1500mA
- Charger Frequency: 100-200kHz
- Charging base dimension: Ø230mm x 11mm

aircharge+

COMPATIBLE WITH
GLASS AND NYLON
CHARGERS

Contactless Digital
Services



aircharge+

DIGITAL MARKER

Designed with
simplicity and
practicality in
mind





COMPATIBLE WITH
GLASS AND NYLON
CHARGERS

Contactless Digital
Services

*Brand shown as example only.

Aircharge+, combined with our wireless charging solution it is the perfect offering to enhance customer experience. Aircharge+ provides digital services tailored to our partner's needs through QR/NFC activation. From table ordering and room service in the hospitality sector to a hot desk and meeting room booking platform in the workplace. We will work alongside our partners to provide a unique and tailored solution that fits the brand and the services they would like to offer their customers/users.



KEY FEATURES:

- Compatible with all glass and nylon surface chargers
- QR Web App launch
- NFC Web App launch
- Co-branding and bespoke full bleed colour & image printing available
- Customisable landing page
- Data connectivity supported



aircharge+

DIGITAL MARKER

Designed with
simplicity and
practicality in
mind

The Aircharge+ smart Digital Marker enables you to turn any table into a smart table. It does not require any power to function and can be easily programmed to digitalise and integrate your mobile services to enable a truly contactless experience at table, without the need of downloading an app.

Co-Branded Solution, Full Bleed Colour & Image Printing



Braille

KEY FEATURES:

- Quick and Easy Install
- Can be glued to table - Perfect for reception areas, lounges and bars
- Durable tempered Gorilla Glass top
- QR Web App launch
- NFC Web App launch
- Co-branding and bespoke full bleed colour & image printing available
- Data connectivity supported

PRODUCT SPECIFICATIONS:

- Finish/colour: Gorilla Glass Black/White
- Material: Aluminium, Gorilla Glass
- Adhesive: 3M Glue

